

# ROD HOLDERS

## COVERED ROD HOLDER

- 316 stainless steel
- Stylish and clean appearance with hidden installation hardware
- Available straight or in 30° angle
- Available both with or without cap
- Comes with replaceable liner

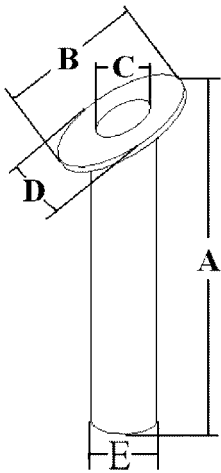

Part No	Angle	A mm	B mm	C mm	D mm	E mm
M7-60-9322363	0°	238 (9 3/8")	98 (3 7/8")	45 (1 3/4")	93 (3 5/8")	51 (2")
M7-60-9322364	0° W/Cap	238 (9 3/8")	98 (3 7/8")	45 (1 3/4")	93 (3 5/8")	51 (2")
M7-60-9122734	30°	250 (9 7/8")	98 (3 7/8")	45 (1 3/4")	93 (3 5/8")	51 (2")
M7-60-9122735	30° W/Cap	250 (9 7/8")	98 (3 7/8")	45 (1 3/4")	93 (3 5/8")	51 (2")
M7-67-9122738	Drain Cup with barb fitting 16mm (5/8")					

## NYLON ROD HOLDER

- Nylon body with or without stainless steel face cover
- Available straight or in 30° angle
- Available both with or without cap
- Face cover to be ordered separately

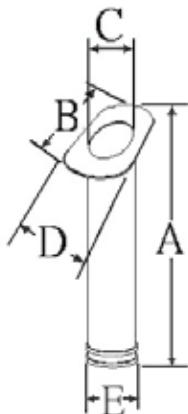

Part No	Angle	A mm	B mm	C mm	D mm	E mm
M7-60-9322380	0° White	260 (10 1/4")	102 (4")	44 (1 3/4")	88 (3 7/16")	53 (2 1/16")
M7-60-9322381	0° Black					
M7-60-9322382	0° White W/Cap					
M7-60-9322383	0° Black W/Cap	273 (10 3/4")	102 (4")	44 (1 3/4")	88 (3 7/16")	53 (2 1/16")
M7-60-8418008	30° White					
M7-60-8418009	30° Black					
M7-60-9122724	30° White W/Cap	273 (10 3/4")	102 (4")	44 (1 3/4")	88 (3 7/16")	53 (2 1/16")
M7-60-9122725	30° Black W/Cap					
M7-60-9018202-1	Face Cover Stainless Steel					

# ROD HOLDERS

## DELUXE STAINLESS STEEL ROD HOLDER - STUDED TYPE

- 316 stainless steel body with plastic liner
- Features a hidden liner
- Concealed mounting studs
- Can be customized with customer logo
- M7-60-9510234-3 without badge

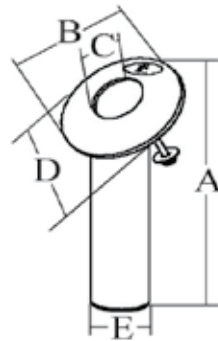
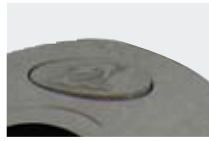

Part No	Angle	A mm	B mm	C mm	D mm	E mm
M7-60-9510234	30°	258 (10 1/8")	119 (4 3/4")	42 (1 5/8")	90 (3 1/2")	51 (2")
M7-60-9510234-3	30°	258 (10 1/8")	119 (4 3/4")	42 (1 5/8")	90 (3 1/2")	51 (2")
M7-60-9510242	15°	285 (11 1/4")	128 (5")	45 (1 3/4")	111 (4 3/8")	57 (2 1/4")
M7-60-9510244	30°	300 (11 7/8")	128 (5")	45 (1 3/4")	111 (4 3/8")	57 (2 1/4")

## DELUXE STAINLESS STEEL ROD HOLDER - SCREW TYPE

- 316 stainless steel body with plastic liner
- Features a hidden liner
- Installation from the top
- Can be customized with customer logo
- M7-60-9510250-3 with out badge

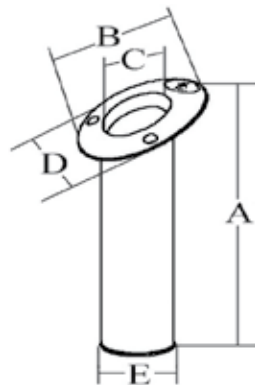

Part No	Angle	A mm	B mm	C mm	D mm	E mm
M7-60-9510250	0°	205 (8")	107 (4 1/4")	42 (1 5/8")	90 (3 1/2")	51 (2")
M7-60-9510250-3	0°	205 (8")	107 (4 1/4")	42 (1 5/8")	90 (3 1/2")	51 (2")
M7-60-9510251	15°	222 (8 3/4")	107 (4 1/4")	42 (1 5/8")	90 (3 1/2")	51 (2")
M7-60-9510253	30°	245 (9 5/8")	107 (4 1/4")	42 (1 5/8")	90 (3 1/2")	51 (2")

# ROD HOLDERS

## DELUXE STAINLESS STEEL ROD HOLDER - STUDED TYPE

- 316 stainless steel body with nylon liner
- Features three mounting studs and cap

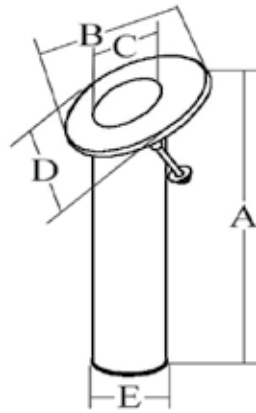

Part No	Angle	A mm	B mm	C mm	D mm	E mm
M7-60-9510139	30°	220 (8 11/16")	119 (4 11/16")	42 (1 5/8")	102 (4")	51 (2")
M7-60-9510255	0°	243 (9 1/2")	128 (5")	45 (1 3/4")	111 (4 3/8")	57 (2 1/4")
M7-60-9510257	15°	263 (10 3/8")	128 (5")	45 (1 3/4")	111 (4 3/8")	57 (2 1/4")
M7-60-9510259	30°	300 (11 13/16")	128 (5")	45 (1 3/4")	111 (4 3/8")	57 (2 1/4")

## ROD HOLDER DRAIN FITTING

- Plastic (TPE)
- Fits 51mm (2") and 57mm (2-1/4") rod holders

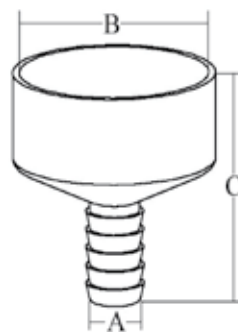

Part No	A mm	B mm	C mm
M7-67-9510236	16 (5/8")	51 (2")	59 (2 5/16")
M7-67-9510246	16 (5/8")	57 (2 1/4")	59 (2 5/16")