

6

5

4

3

2

1

REVISION HISTORY			
REV	DATE	BY	DESCRIPTION
B	11NOV09	JT	PRN: P2008-1210
C	23MAR09	JT	PRN: P2009-0368
D	06JUL09	JT	PRN: 2009-0812
E	16FEB10	JT	PRN: P2010-0159
F	19APR10	DAS	PRN: P2010-0369
G	20MAY10	JT	PRN: P2010-0529

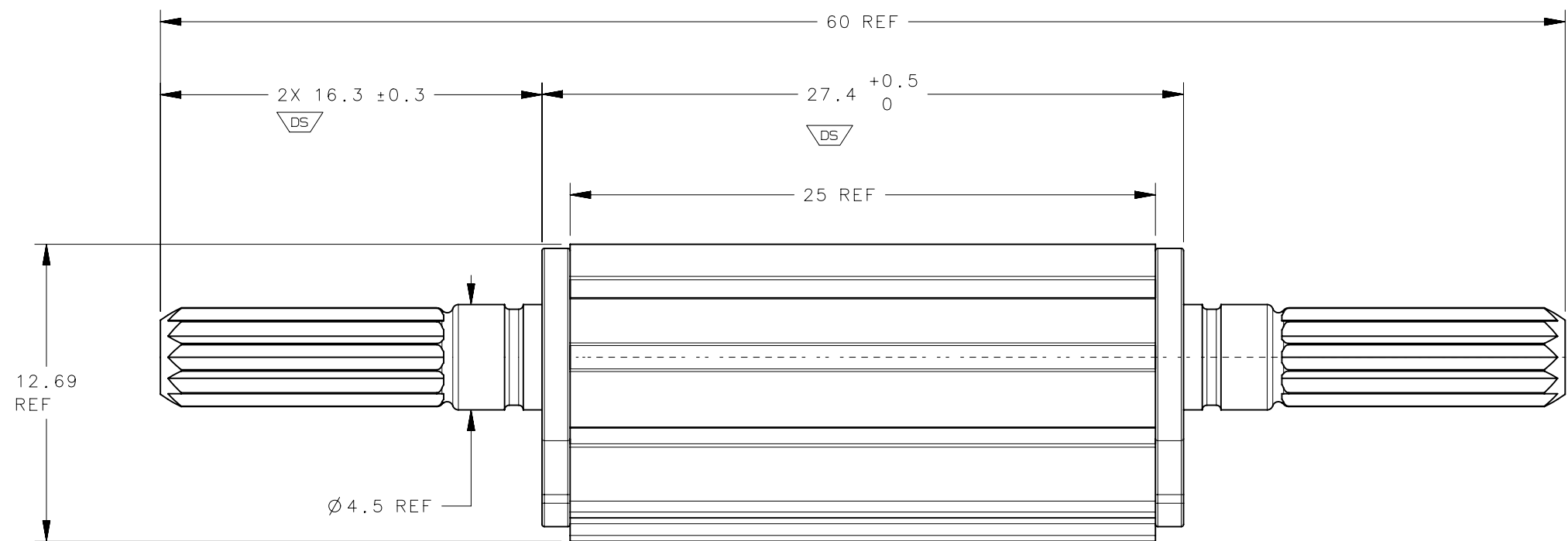
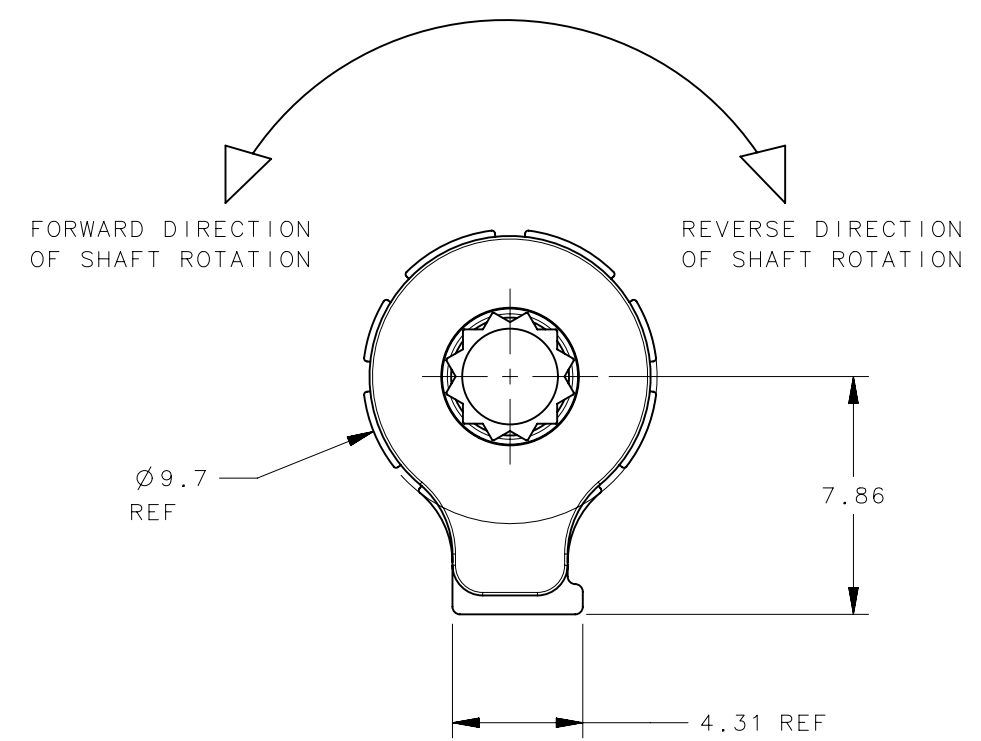

PART NUMBER	STATIC TORQUE +/-20%	
	FORWARD TORQUE N-m (in-lbf)	REVERSE TORQUE N-m (in-lbf)
ST-11P-140SA-[50]	1.58 (14)	1.58 (14)
ST-11P-200SA-[50]	2.26 (20)	2.26 (20)
ST-11P-260SA-[50]	2.94 (26)	2.94 (26)
ST-11P-140FA-[50]	1.58 (14)	0.95 (8.4)
ST-11P-200FA-[50]	2.26 (20)	1.36 (12)
ST-11P-260FA-[50]	2.94 (26)	1.76 (15.6)
ST-11P-320FA-[50]	3.62 (32)	2.17 (19.2)
ST-11P-140RA-[50]	0.95 (8.4)	1.58 (14)
ST-11P-200RA-[50]	1.36 (12)	2.26 (20)
ST-11P-260RA-[50]	1.76 (15.6)	2.94 (26)
ST-11P-320RA-[50]	2.17 (19.2)	3.62 (32)

- NOTES:
- PERFORMANCE TORQUE TOLERANCE ±20%
 - MATERIAL ALUMINUM, STEEL, AND ACETAL
 - CYCLE LIFE TO BE 20,000 CYCLES WITH LESS THAN 20% TORQUE CHANGE FROM MANUFACTURED VALUE

THIRD ANGLE PROJECTION		southco [®] CONNECT • CREATE • INNOVATE	
MILLIMETERS [IN]			
TOLERANCES UNLESS OTHERWISE NOTED		DESCRIPTION HINGE ASSEMBLY	
ALL DIMENSIONS WITHOUT TOLERANCES ARE FOR REFERENCE ONLY.		SIZE B	SYSTEM NX
PER ASME Y14.5M-1994		DWG NO. J-ST-11P	DATE 17NOV08
EXCEPT FOR USES EXPRESSLY GRANTED IN WRITING, INFORMATION DISCLOSED HEREON IS CONFIDENTIAL AND ALL RIGHTS, PATENT AND OTHERWISE, ARE RESERVED BY SOUTHCO, INC.		SCALE 1:1	SHEET 1 OF 1

6

5

4

3

2

1