

6

5

4

3

2

1

REVISION HISTORY			
REV	DATE	BY	DESCRIPTION
A	N/A	-	-
B	17NOV08	JT	PRN: P2008-1201
C	23MAR09	JT	PRN: P2009-0368
D	06JUL09	JT	PRN: P2009-0812
E	17FEB10	JT	PRN: P2010-0159
F	19APR10	DAS	PRN: P2010-0369

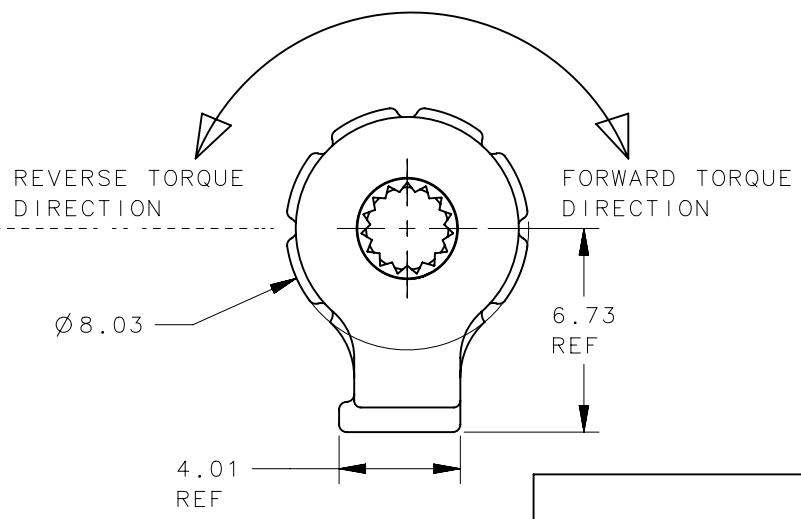
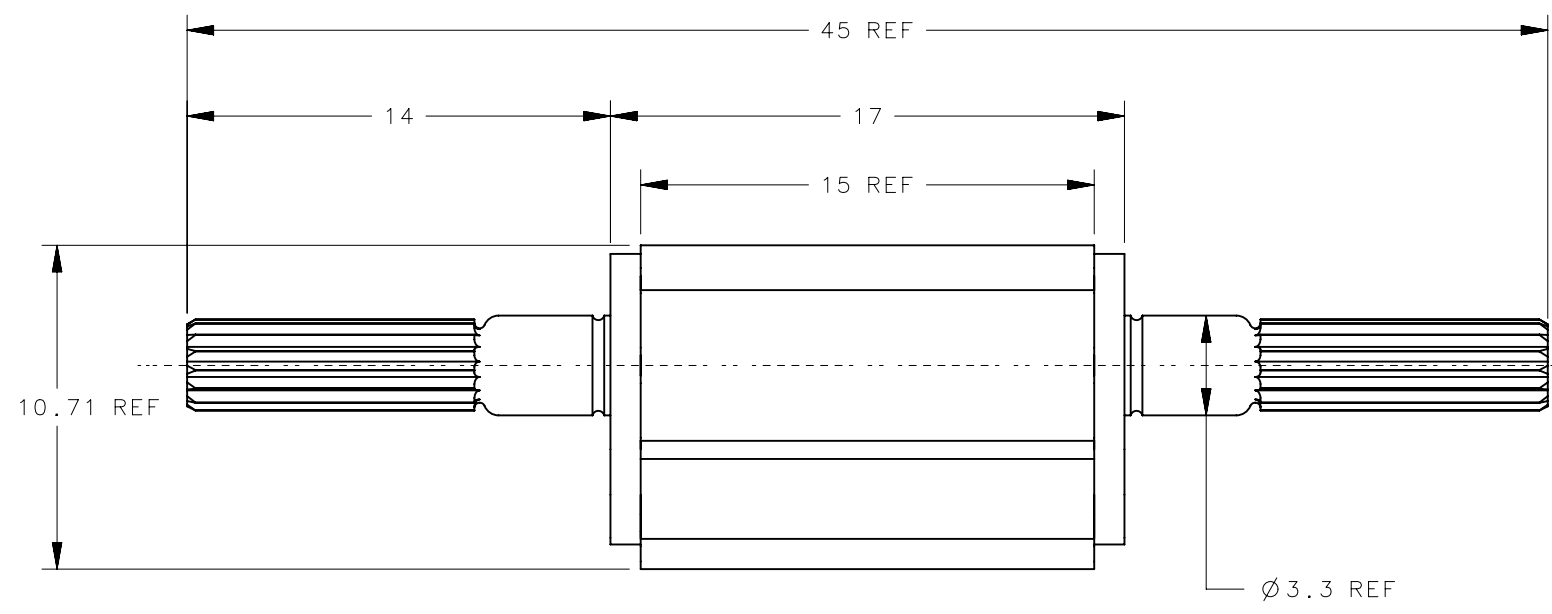
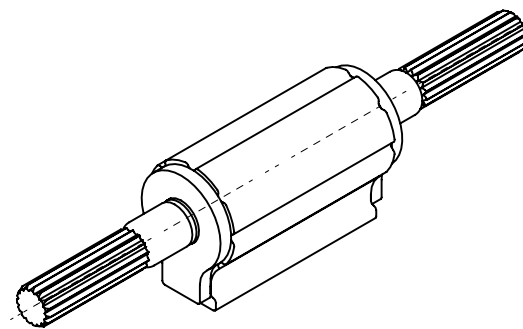

PART NUMBER	STATIC TORQUE +/-20%	
	FORWARD TORQUE N-m (in-lbf)	REVERSE TORQUE N-m (in-lbf)
ST-8P-40SA-[50]	0.45 (4.0)	0.45 (4.0)
ST-8P-60SA-[50]	0.68 (6.0)	0.68 (6.0)
ST-8P-80SA-[50]	0.90 (8.0)	0.90 (8.0)
ST-8P-40FA-[50]	0.45 (4.0)	0.27 (2.4)
ST-8P-60FA-[50]	0.68 (6.0)	0.41 (3.6)
ST-8P-80FA-[50]	0.90 (8.0)	0.54 (4.8)
ST-8P-100FA-[50]	1.13 (10.0)	0.68 (6.0)
ST-8P-40RA-[50]	0.27 (2.4)	0.45 (4.0)
ST-8P-60RA-[50]	0.41 (3.6)	0.68 (6.0)
ST-8P-80RA-[50]	0.54 (4.8)	0.90 (8.0)
ST-8P-100RA-[50]	0.68 (6.0)	1.13 (10.0)

NOTES:

1. CYCLE LIFE TO BE 20,000 CYCLES WITH LESS THAN 20% TORQUE CHANGE FROM MANUFACTURED VALUE
2. CIRCLED DIMENSIONS AND SPECIFIED CHARACTERISTICS IN NOTES ARE INSPECTION PARAMETERS TO BE USED FOR STATISTICAL PROCESS CONTROL

THIRD ANGLE PROJECTION		 CONNECT • CREATE • INNOVATE	
MILLIMETERS [IN]			
SURFACE AREA XXXXXmm ²		DESCRIPTION Hinge & Controlled Motion Device	
VOLUME XXXXXmm ³		SIZE B SYSTEM NX DWG NO. J-ST-8P	
PROPRIETARY ITEM		DRAWN BY DATE 06JAN09 SCALE 1:1 SHEET 1 OF 1	
EXCEPT FOR USES EXPRESSLY GRANTED IN WRITING, INFORMATION DISCLOSED HEREON IS CONFIDENTIAL AND ALL RIGHTS, PATENT AND OTHERWISE, ARE RESERVED BY SOUTHCO, INC.		PER ASME Y14.5M-1994	

6

5

4

3

2

1